



Maintaining the Home

Fixing Plugged Sink or Lavatory Drains

Maintaining the Home: Fixing Plugged Sink or Lavatory Drains

If all other sink and toilet drains are open the blockage is probably local.

1. Check the stopper for accumulations of hair, soap and other foreign material. If a plain rubber stopper is used the accumulation is probably on the grate in the drainpipe just below the stopper. Proceed as described for slow emptying lavatories.
2. Some mechanical stoppers can just be pulled out, others can be lifted, turned and raised, still others require disassembling the unit. Take the stopper out and remove all hair and foreign material.
3. If the stopper will not come out you have a more difficult problem. Remove the trap below the sink as described in Step 4. Also remove as much of the pipe to the bowl as possible. Now with a wire with a short hook, clean the hair out by working both from below and above the sink.
4. After the bowl drain is free, remove the bottom of the trap below the lavatory by turning the two large nuts. The nuts are on the pipes so turn them counter-clockwise as you look at them from the pipes. Be sure to put a bucket under the trap to catch the water which accumulates in the trap. Clean out the trap with hot soapy water. ([Vis. 1](#))

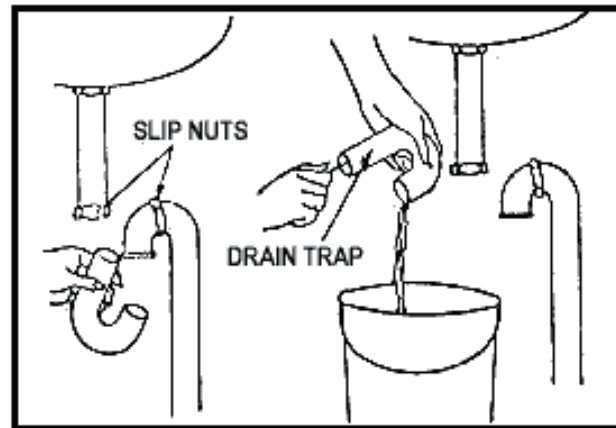

5. Insert a plumber's "spring snake" into the drain pipe and turn it as it goes into the pipe. There is usually a hook on the tip which will catch on whatever is in the pipe. If and when you feel it catch, pull it back out. Do not try to push it through. Usually a plumbing fixture is within 5 or 6 feet from a vertical pipe so if the snake goes through to this pipe you can feel it on the snake and the system should drain.

*This resource is one in a series on **Maintaining the Home** which include:*

Interior Maintenance

Preventive Home Maintenance Checkup
Make a Basic Toolkit for Simple Home Repairs
Selection and Use of Home Cleaning Products
Discovering the Secrets of Successful Storage

Heating

Furnace Care
Fireplace and Chimney Care

Cooling

Evaporative Cooler
Air Conditioner
Ceiling Fans

Plumbing

Fixing Plugged Sink Drains
How to Unclog a Toilet
Repairing Dripping Faucets

Electrical

How to Set or Reset a Circuit Breaker
How to Replace a Fuse

Appliances

How to Buy an Energy Efficient Home Appliance
Choosing a Water Heater

Maintenance:

Dishwasher Care and Dishwasher Cleaning
Dryer Care and Dryer Cleaning
Freezer Care and Freezer Cleaning
Garbage Disposal Care and Cleaning
Range and Oven Care and Range Cleaning
Refrigerator Care and Refrigerator Cleaning
Small Electrical Appliance Care and Cleaning
Washer Care and Cleaning

Flooring

Buying new carpet
Carpet Care and Cleaning
Wood Floors Care and Cleaning
Ceramic Tile Floors Care and Cleaning
Vinyl Floor Coverings Care and Cleaning

Walls

Selecting and Applying Paint
Wallpaper Selection and Cleaning
Repairing Walls

Furniture

Furnishing Your New Home: Color and Design
Selecting Fabric For Home Furnishings

Exterior Maintenance

Home Exterior

Foundations, Basements and Yards
Exterior Walls, Windows, and Doors

Roof

A Guide To Roofs
Roof Maintenance

Landscaping and Lawn Care

Principles of Xeriscape
Watering Your Lawn

Home Safety

Child-Proofing Your Home
Is Your Home Safe From Fire Hazards?
Smoke Alarms Save Lives
Carbon Monoxide Alarms
Are Your Children Safe From Poisons?
Protecting Yourself Against Burglary

Conservation

Weatherize Your Home
Easy Tips to Save Money and the Planet
How to Stop Air Leaks Around Windows
Energy-Efficient Heating and Cooling
Indoor Water Conservation Tips
Outdoor Water Conservation Tips

Environment Issues

Green Building
Reduce-Reuse-Recycle: Alternatives for Waste Management
Create a home recycling center
Healthy Indoor Air for New Mexico Homes
Dealing with Mold
Household Hazardous Waste
Hazardous Household Substances: Alternatives That Are Relatively Free of Toxic Effects
Radon

Pest Control

Cockroaches and Their Control
Southwest Insects

Accessible Living

Update your home for a lifetime of living
Vision Loss & Hearing Loss
Hand Dexterity, Strength and Range of Motion
Cognitive Difficulties
Mobility Impairments, Balance and Coordination

Sponsored by New Mexico State University and the City of Las Cruces. Supported by U.S. Department of Housing and Urban Development. New Mexico State University is an equal opportunity/affirmative action employer and educator. NMSU and the U.S. Department of Agriculture cooperating. © 2005 NMSU Board of Regents. All rights reserved.



Maintaining the Home: Fixing Plugged Sink or Lavatory Drains